

Since 2002, Vegreville Manor has been providing a 55-suite supportive housing option where you can live independently, have the security and convenience of on-call assistance, be proactive about your health and enjoy a maintenance-free environment.

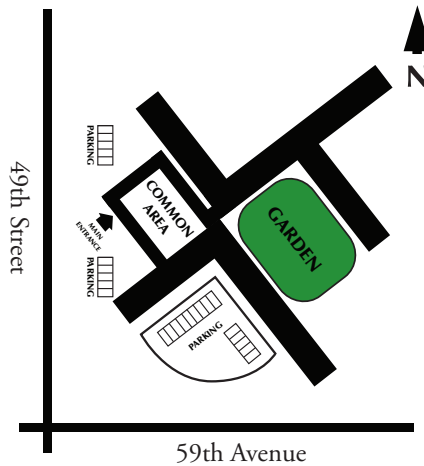

Vegreville Manor  
5913 – 49 Street  
Vegreville, Alberta T9C 1X4  
Manager Tel: 780.632.3540  
Fax: 780.603.0861  
E-mail: [smmv@digitalweb.net](mailto:smmv@digitalweb.net)  
[www.smhg.ca](http://www.smhg.ca)



**St. Michael's**  
HEALTH GROUP

St. Michael's Health Group  
7404 – 139 Avenue  
Edmonton, Alberta T5C 3H7  
Tel: 780.473.5621 • Fax: 780.472.4506  
Toll Free: 1.800.472.6169  
E-mail: [smeccs@smhg.ca](mailto:smeccs@smhg.ca)  
[www.smhg.ca](http://www.smhg.ca)



**St. Michael's**  
HEALTH GROUP

# Vegreville Manor





# Vegreville Manor



## General Services

- Studio, one-bedroom and two-bedroom suites
- Complete kitchenette in each suite
- Activities room, lounge and recreation areas
- Secured entrances and exits
- Arrangements for pastoral care
- Recreation and social activities
- Landscaped courtyards with activity area
- Three full meals per day Dietician approved (based on the Canada Food Guide) through on-site cook's service staff
- Daily snacks and beverages
- Housekeeping services on a scheduled basis
- Laundry on the premises; personal laundry services available
- Volunteer involvement from the community
- Hair salon (men's and women's on a scheduled and by appointment basis)
- Sprinkler system and smoke detectors throughout the facility
- Wheelchair accessible
- Access to community social work

## Health Services

- Access to home care support
- Assisted bath
- 24 hour emergency response
- Management of medical emergencies
- Exercise program
- Special care during short-term illness
- Pharmaceutical services available

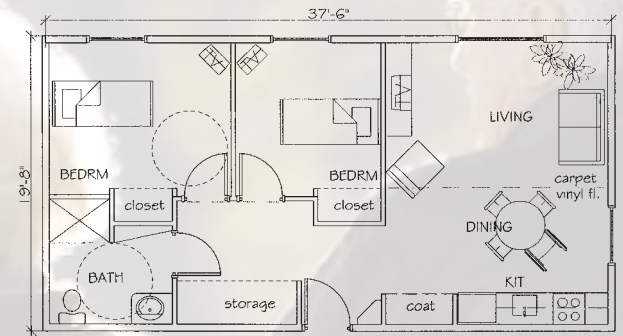

UNIT A - 2 BEDROOM SUITE  
737sq ft

BEDRM WINDOW -4'-0"X5'-0" typical  
LIVINGRM WINDOW -6'-0"X5'-0" typical

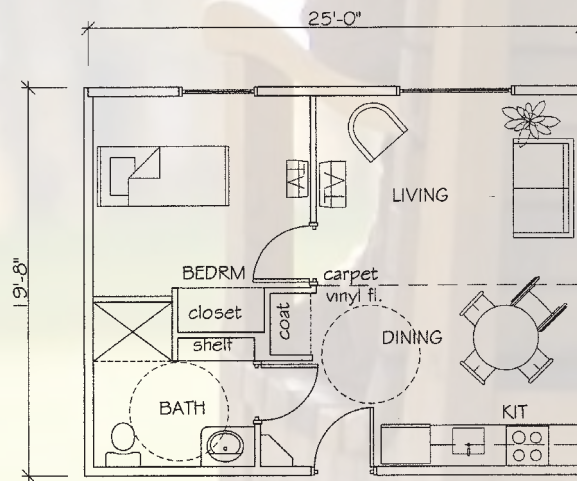

UNIT B - 1 BEDROOM SUITE  
492sq ft

BEDRM WINDOW -4'-0"X5'-0" typical  
LIVINGRM WINDOW -6'-0"X5'-0" typical

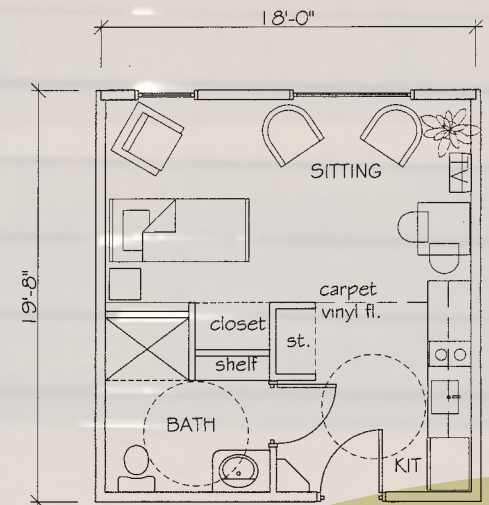

UNIT C - STUDIO SUITE  
354sq ft

BEDRM WINDOW -3'-0"X5'-0" typical  
LIVINGRM WINDOW -6'-0"X5'-0" typical